

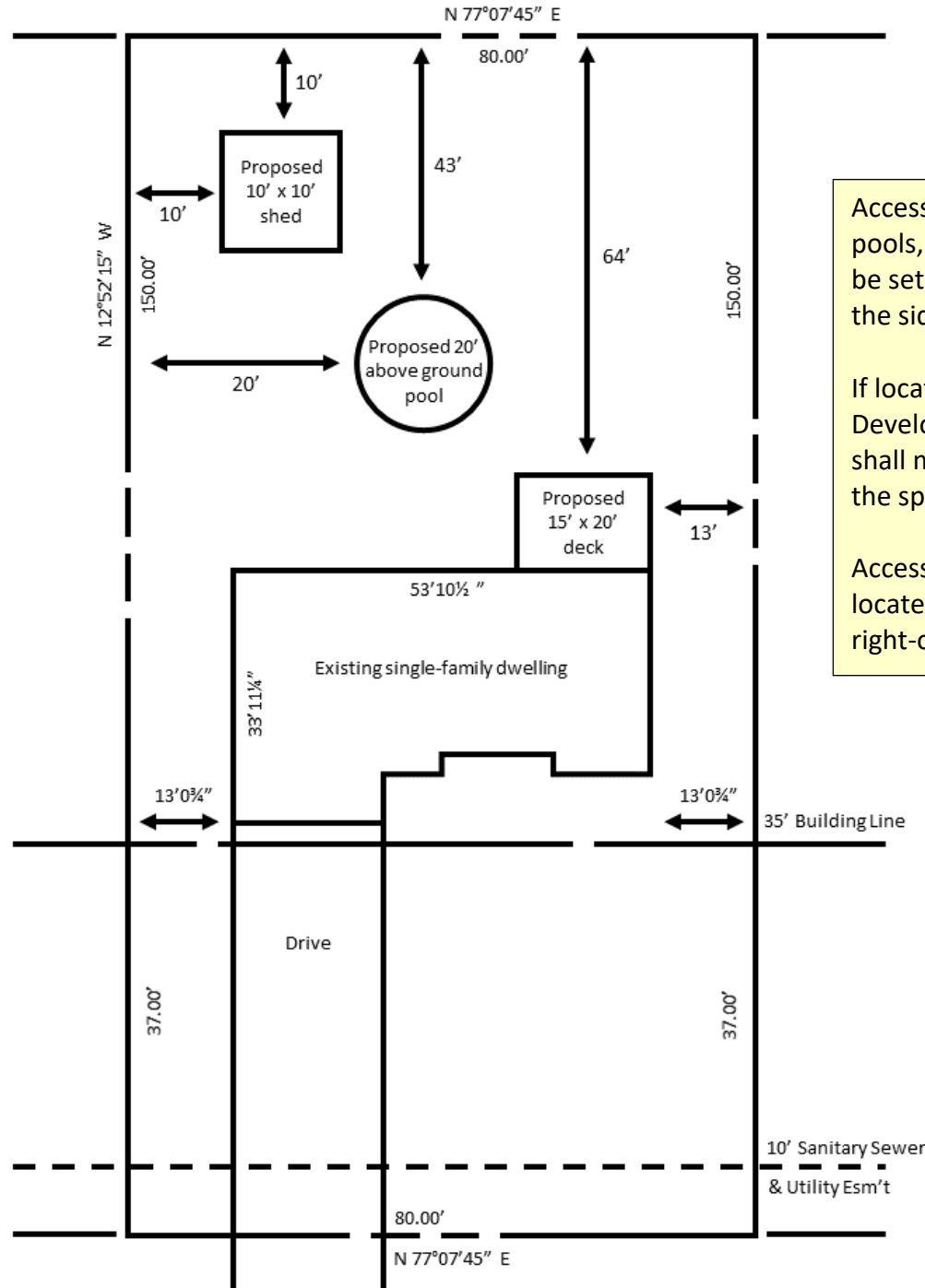

**Sample Residential Survey**



Accessory structures (sheds, decks, pools, greenhouses, and similar) shall be set-back a minimum of 5 feet from the side and rear property lines.

If located in a Planned Residential Development (PRD), the set-backs shall meet the required distances in the specific PRD.

Accessory structures also cannot be located on or over an easement or right-of-way.

**LOT 204**

**LOT 203**

**LOT 202**

**TOWNSHIP DRIVE 50'**